

Level Crossing Technology Trial Dandaloo Road and Old Backwater Road, Narromine

August 2023



Transport for NSW acknowledges the Wiradjuri people as the Traditional Custodians of the lands on which we work and pays respect to Elders past and present.

Transport for NSW is trialling new technology at three level crossings in regional NSW.

The trials are designed to improve safety at railway level crossings by improving driver awareness of the level crossing and its risk.

What is happening?

Three passive level crossings will be made safer in a trial of radar-activated LED stop and advance warning signs.

The following technologies are installed at:

Dandaloo Road, Narromine

- Augmented Stop Sign

Old Backwater Road, Narromine

- Advance Warning Sign

Mary Gilmore Way, Bribbaree

- Advance Warning Sign
- Augmented Stop Sign

To view a video of the signs and how they operate visit transport.nsw.gov.au/lxtrial

Advance Warning Sign

The advance warning signs with orange 'wig wag' lights will flash if an approaching motorist is not slowing down to prepare to stop at the level crossing. The warning sign system uses solar and battery power to provide reliability and resilience in regional conditions.



Augmented Stop Sign

The augmented stop sign has LED red lights constantly illuminated in daylight, to increase driver awareness of the stop sign at the level crossing.

The augmented stop sign's lights will flash during daylight if an approaching motorist is not slowing down to prepare to stop at the level crossing.

During the trial, the augmented stop sign lights will **only operate in daylight**.

The augmented stop sign system uses solar and battery power to provide reliability and resilience for regional conditions.



Location of trial signs

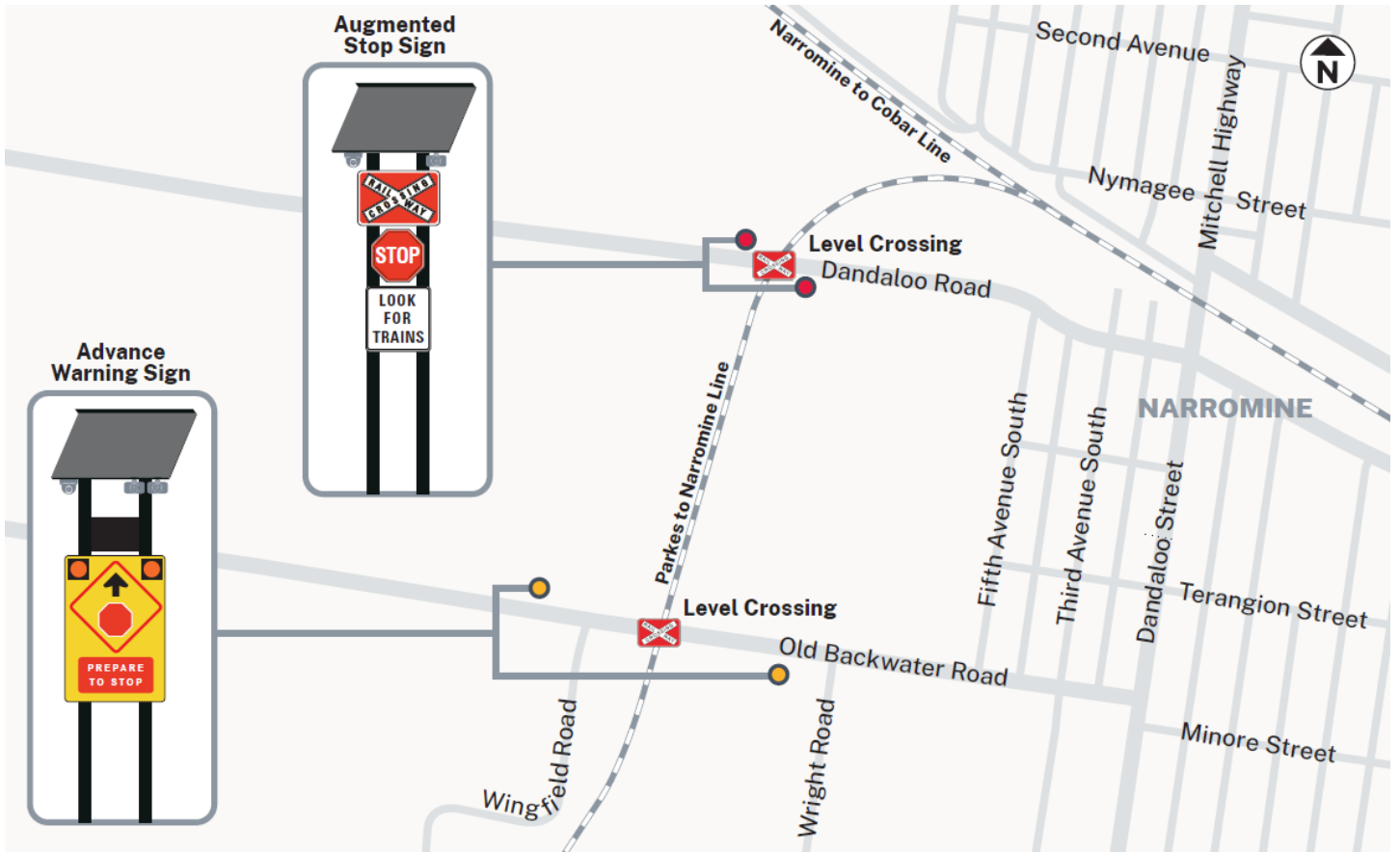

Background

There are more than 2700 level crossings on operational NSW rail network lines. This excludes any level crossings in private rail yards and on non-operational rail lines.

In NSW, 1307 level crossings are on public roads, of these, 858 level crossings are controlled by a stop or give way sign.

Between 2001 and 2021 there were 164 crashes at level crossings between trains and road vehicles in NSW, resulting in 16 fatalities and 26 serious injuries.

Following a fatal level crossing crash in regional NSW in 2021, the Emerging Technologies branch of Transport for NSW were tasked with exploring new technologies to improve level crossing safety.

Contact us



Project Infoline **1800 167 499**



western.projects@transport.nsw.gov.au



transport.nsw.gov.au/lxtrial

www.transport.nsw.gov.au/privacy-statement#Your_Privacy