



# Transport Access Program

## Banksia Station Upgrade

**Project Update**

**May 2021**

Transport for NSW is improving accessibility at Banksia Station. The upgrade will provide a station precinct that is accessible to people with a disability or limited mobility, parents/carers with prams, and customers with luggage.

### Upcoming work

Work will continue in May and includes:

- ongoing demolition work in the station underpass and station structure
- continued structural steelwork on Hattersley Street
- continued roofing and building work
- commencement of work to station toilets and building on platforms 2 & 3
- constructing new retaining walls and new stairs on platforms 1 and 4
- continued electrical work on Hattersley Street including installing a new electrical transformer
- continued storm water drainage work on Hattersley Street, Railway Street and in the underpass
- new footpath and kerb on Railway Parade (temporary bus stop relocation in place).

Equipment to be used includes cranes, tipper trucks, delivery trucks, excavators, vacuum truck, powered hand tools, ground compaction equipment and concrete trucks.

### Ongoing pedestrian access and parking changes

Between **5 and 6 May** structural steelwork will be installed for the new lift on Hattersley Street. Pedestrian access to the underpass and vehicle access along Hattersley Street will be managed with traffic control.

Temporary stairs remain in place to provide access to both platforms 1 and 4.

Pedestrians who require access to Platform 1 will be required to detour across Railway Street as per the bus stop relocation map overleaf. Up to six parking spaces will be temporarily unavailable on Railway Street to allow for the bus stop relocation. These changes are expected to be in place until Friday 18 June 2021.

Three parking spaces on Taylor Avenue and up to 12 parking spaces on Hattersley Street are temporarily unavailable as they are being used for construction vehicles and deliveries. The taxi zone on Railway Street will be unavailable at times during work near the station entrance. These changes will be in place until mid-2021.

We apologise for the inconvenience and thank you for your patience while we complete this work.

For more information call **1800 684 490**,

Email [projects@transport.nsw.gov.au](mailto:projects@transport.nsw.gov.au) or visit [transport.nsw.gov.au/banksia](https://transport.nsw.gov.au/banksia)

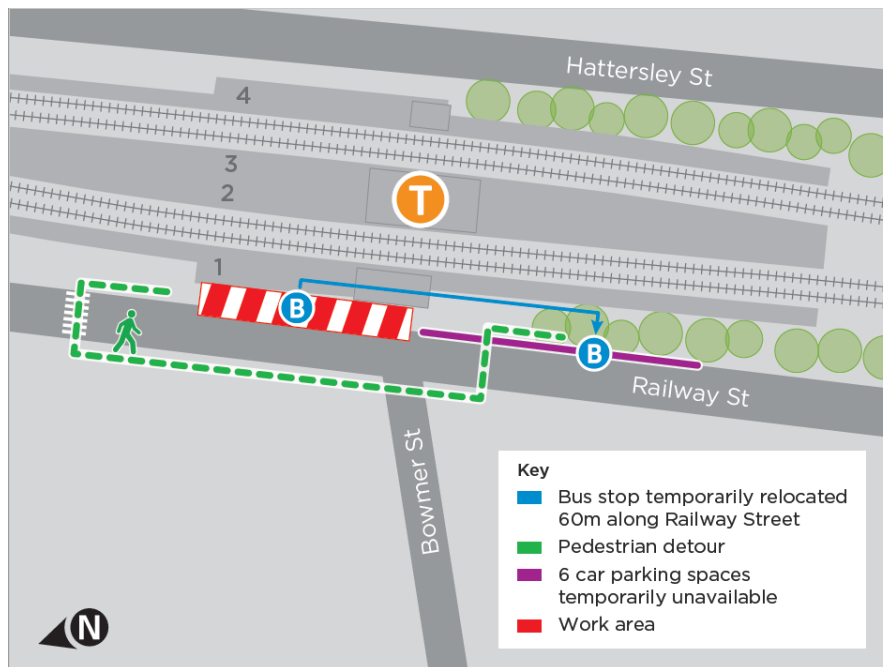

Temporary bus stop relocation and pedestrian detour map

## Construction hours

Standard construction hours are **7am to 6pm Monday to Friday** and **8am to 1pm on Saturdays**.

For the safety of staff, customers and the community some work may be completed outside standard construction hours. Nearby residents and businesses will be notified before any work outside these hours takes place.

## Keep in touch

We will continue to keep the community informed with regular project notifications and frequent online updates published to the project website [www.transport.nsw.gov.au/banksia](http://www.transport.nsw.gov.au/banksia).

If you would like to be added to the project distribution list, or for more information about the Banksia Station Upgrade, please contact us on 1800 684 490 or email [projects@transport.nsw.gov.au](mailto:projects@transport.nsw.gov.au). For all urgent enquiries or complaints regarding construction activities, please call our 24-hour Construction Response Line on 1800 775 465.

Thank you for your patience during this important work.



This document contains important information about public transport projects in your area. If you require the services of an interpreter, please contact the Translating and Interpreting Service on **131 450** and ask them to call Transport for NSW on **1800 684 490**. The interpreter will then assist you with translation.

For more information call **1800 684 490**,

Email [projects@transport.nsw.gov.au](mailto:projects@transport.nsw.gov.au) or visit [transport.nsw.gov.au/banksia](http://transport.nsw.gov.au/banksia)