

# Fleet update

Transport for NSW is investing in new trains and ferries to provide more comfortable, reliable, efficient and accessible journeys for our customers. To keep you informed, we will regularly provide an update on our new fleet projects. If you would like to subscribe to this newsletter please send an email to [projects@transport.nsw.gov.au](mailto:projects@transport.nsw.gov.au)

## First new Waratah Series 2 train arrives

During March the first of 24 new Waratah Series 2 air-conditioned suburban trains arrived in Australia for testing and commissioning. These new trains are needed to support increasing patronage across the network and growing demand for services.

The Waratah Series 2, part of the \$1.5 billion More Trains More Services program, will allow for the phased retirement of the older S-sets.

The Waratah Series 2 trains will improve customer comfort and accessibility including features such as:

- improved air conditioning with advanced temperature control
- more than 90 internal and external CCTV cameras and two customer help points per car

- priority seating, wheelchair spaces and hearing aid loops
- high definition customer information screens to provide journey and safety information
- improved interior LED lighting.

The new train will undergo testing over the next few months to ensure a safe and reliable journey for future passengers. The new trains will arrive progressively with the first trains expected to be in passenger service by late 2018.

Once the 24 new trains are in operation and proven reliable, the non-air-conditioned S-sets will be gradually retired.

**Would you like to know more?** Visit [transport.nsw.gov.au/projects/current-projects/sydney-growth-trains](http://transport.nsw.gov.au/projects/current-projects/sydney-growth-trains)



*The first of the 24 new Waratah Series 2 trains*

For more information call 1800 684 490  
Email [projects@transport.nsw.gov.au](mailto:projects@transport.nsw.gov.au) or visit [transport.nsw.gov.au/projects](http://transport.nsw.gov.au/projects)  
For urgent enquiries or complaints regarding construction activities,  
please call 24 hours 1800 775 465

# New Intercity Fleet

The NSW Government is delivering a New Intercity Fleet to replace trains currently carrying customers from Sydney to the Central Coast, Newcastle, the Blue Mountains and the South Coast.

The new state-of-the-art trains will replace the ageing V-Sets to provide customers with a more comfortable and reliable journey.

The first trains in the New Intercity Fleet will begin services progressively from late next year.

## Train design update

Detailed design of the new trains has started.

As part of the detailed design, user engagement sessions will start over the next few months with staff, disability groups, customers and other specific user groups like travellers with luggage and parents with prams. This will further inform and refine the design.

The trains will feature wider, more spacious seats with arm rests, charging facilities for mobile devices, two by two seating for extra room and comfort, dedicated spaces for luggage, prams, bicycles and wheelchairs, improved accessibility including accessible toilets, cup holders and tray tables, improved customer information through digital information screens and announcements, CCTV and help points and modern air conditioning.

The layout of seating will be similar to that of the Tangara trains. Rows of seats in the middle of the carriage will be back-to-back, with the seats at either end of the saloon facing each other to cater for families and groups travelling together. See artist's impression below.

## Why are seats not reversible?

We know that comfort is especially valued by our intercity customers who are travelling longer distances, and the New Intercity Fleet has been designed with this in mind.

We've asked customers what they value and incorporated much of this feedback into the design, including two by two seating with wider seats, arm rests and wider aisles, as well as amenities like tray tables and charging outlets for mobile devices.

According to our research, the main benefit of reversible seating for customers was being able to face the direction of travel and for families and groups travelling together to be able to face each other.

The seat configuration on board the New Intercity Fleet will mean that half of the seats will be facing the direction of travel, while the seats at either end of the saloon will cater for families and groups.

Reversible seating could only have been accommodated by significantly compromising on comfort and seating amenities. Customer feedback indicated that comfort was a key priority.

Reversible seating takes up more space than fixed seating and would have reduced the number of seats available for customers.

Power for charging mobile devices at the seat and tray tables would also not have been possible without fixed seating.



Artist's impression of the New Intercity Fleet. These are representative of the preliminary design and subject to change during detailed design activities.

For more information call 1800 684 490

Email [projects@transport.nsw.gov.au](mailto:projects@transport.nsw.gov.au) or visit [transport.nsw.gov.au/projects](http://transport.nsw.gov.au/projects)

For urgent enquiries or complaints regarding construction activities, please call 24 hours 1800 775 465



Artist's impression of the New Intercity Fleet. These are representative of the preliminary design and subject to change during detailed design activities.

### Ten Tunnels Deviation Modifications

Minor modifications to the Ten Tunnels Deviation (between Newnes Junction Station and Zig Zag Station) are needed to enable through services to Lithgow on the New Intercity Fleet.

The Project includes:

- minor modifications to sections of the lining of eight of the tunnels (called 'notching'). The deepest notching would be approximately 130 millimetres
- the installation of rock bolts and replacement of lighting shields.

Through detailed studies and engineering, the Assets Standards Authority at Transport for NSW has been able to develop a much tighter set of standards for the design and maintenance of this track, and the design of operation of these new trains. This will allow for the New Intercity Fleet to operate safely on this section of the Blue Mountains Line.

A Review of Environmental Factors (REF) was prepared to assess the potential impacts and mitigation measures for the project. Community feedback was invited during February. The feedback will help further develop the project. A copy of the REF is available on the project website [transport.nsw.gov.au/projects/current-projects/new-intercity-fleet](http://transport.nsw.gov.au/projects/current-projects/new-intercity-fleet).

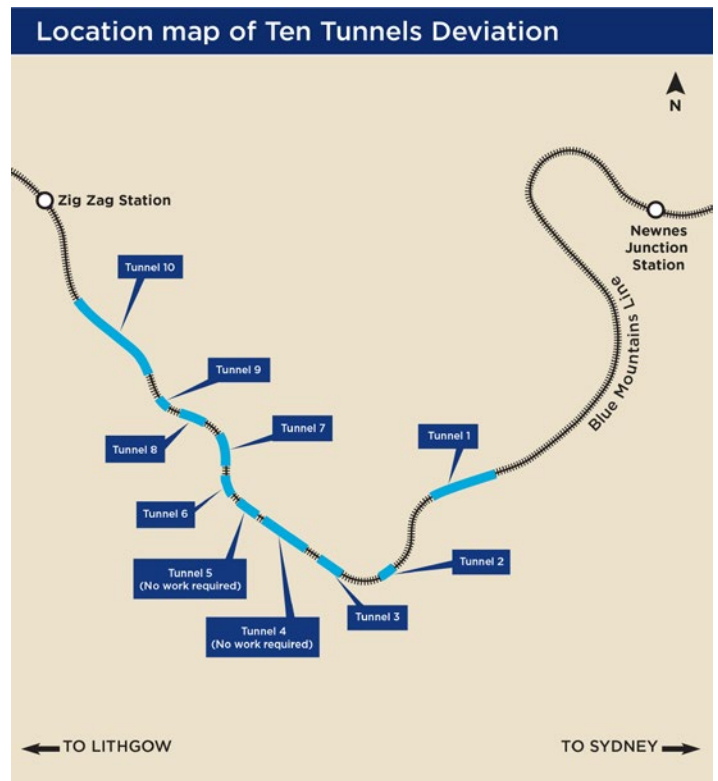

**Would you like to know more?** Visit [transport.nsw.gov.au/projects/current-projects/new-intercity-fleet](http://transport.nsw.gov.au/projects/current-projects/new-intercity-fleet)

For more information call 1800 684 490  
 Email [projects@transport.nsw.gov.au](mailto:projects@transport.nsw.gov.au) or visit [transport.nsw.gov.au/projects](http://transport.nsw.gov.au/projects)  
 For urgent enquiries or complaints regarding construction activities,  
 please call 24 hours 1800 775 465

## Maintenance Facility

A contract has been awarded for the design and construction of a new maintenance facility at Kangy Angy on the Central Coast to service and maintain the New Intercity Fleet.

Early work activities are now underway. Early work includes surveys, geotechnical investigations, minor vegetation removal and service investigations.

Major construction is expected to start in mid-2018.

The artist impression image below shows a preliminary design of the maintenance facility at Kangy Angy. This image is indicative only and subject to change through the detailed design process.

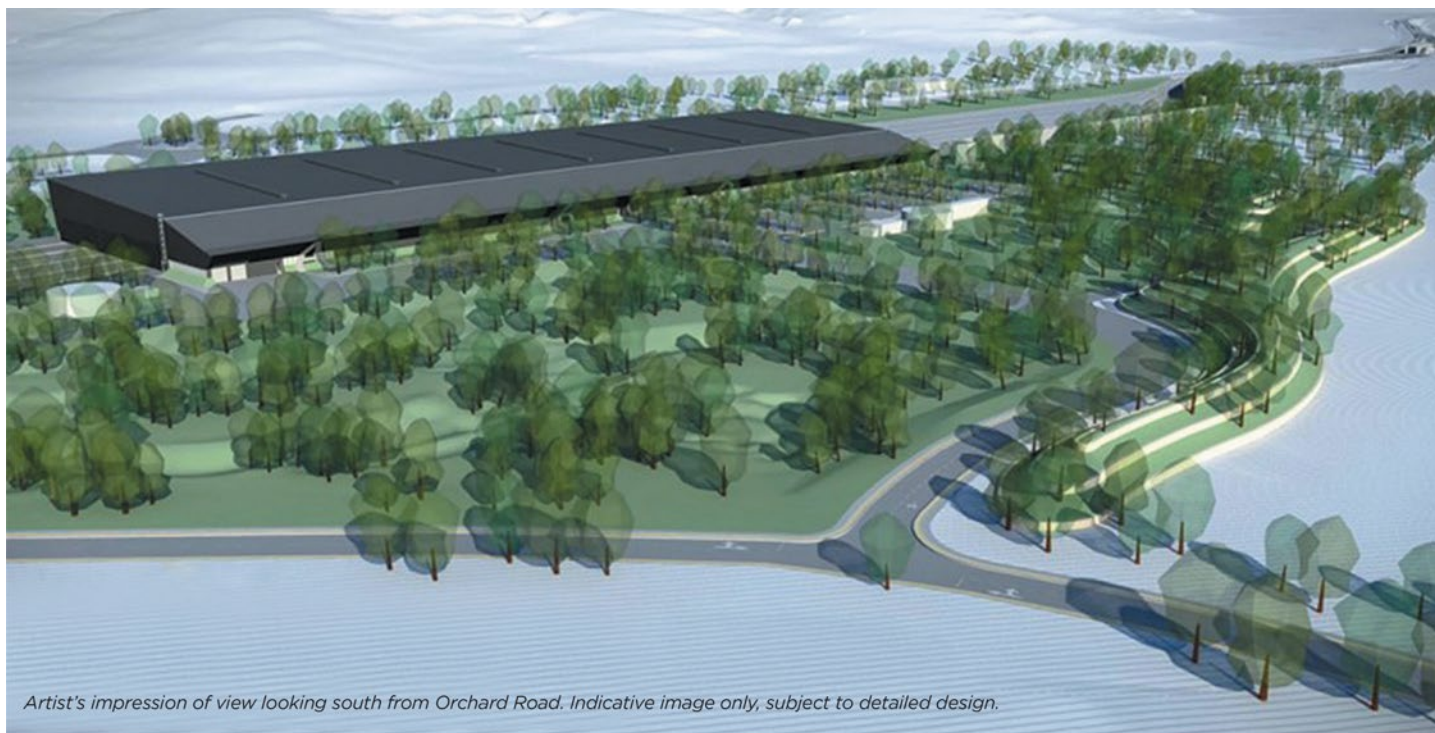

*Artist's impression of view looking south from Orchard Road. Indicative image only, subject to detailed design.*

## Stations and Signalling Modifications

Modifications and upgrades are needed to existing rail infrastructure at various locations across the electrified network to accommodate the New Intercity Fleet.

This includes:

- platform extensions
- modifications to infrastructure within the rail corridor, including the installation and relocation of signalling and overhead wiring structures
- trackwork

- installation of balises and car markers
- installation of CCTV, PA, lighting and station furniture, where required.

A contract has been awarded to Downer EDI Works Pty Ltd to deliver the project, which includes the design and construction of the modifications.

Site investigations started in January 2018 and construction is expected to start in mid-2018. The majority of work will take place during scheduled Sydney Trains trackwork weekends.

**Would you like to know more?** Visit [transport.nsw.gov.au/projects/current-projects/new-intercity-fleet](https://transport.nsw.gov.au/projects/current-projects/new-intercity-fleet)

For more information call 1800 684 490

Email [projects@transport.nsw.gov.au](mailto:projects@transport.nsw.gov.au) or visit [transport.nsw.gov.au/projects](https://transport.nsw.gov.au/projects)

For urgent enquiries or complaints regarding construction activities, please call 24 hours 1800 775 465

# Regional Rail Project

The NSW Government is delivering new regional and intercity diesel trains for services from Sydney to many regional centres in NSW, as well as interstate destinations such as Canberra, Melbourne and Brisbane.

The new fleet of modern trains will improve the safety, comfort and reliability of regional train services. Coming into service progressively, the first trains are anticipated to be delivered in the early 2020s.

The trains will replace the ageing regional and intercity diesel trains (XPT, XPLOER and Endeavour), which are approaching the end of their lifetime.

The new fleet will improve the safety, level of comfort and reliability of regional train services.

The project is currently in the tender phase. In February representatives from the three companies shortlisted to deliver the new regional rail fleet and maintenance facility – Regional Futures, Bombardier Consortium and Momentum Trains – visited the preferred site for the maintenance facility in Dubbo.

This was the first opportunity for the applicants to see the site and ask questions about the project as they prepare their Request for Proposal submissions.

We aim to award a contract for the new fleet in early 2019 with the first trains anticipated to be on the tracks in the early 2020s. The new trains will be operated by NSW TrainLink.

## Regional Rail Maintenance Facility

A new purpose-built maintenance facility for the new regional fleet will be built in Dubbo, NSW, subject to planning approval. The new facility will service and maintain the new fleet and will help to stimulate the regional economy and create sustainable employment opportunities including traineeships and apprenticeships.

The contract for the new fleet will deliver 100 per cent of train completion works to be done in NSW, with a preference for regional NSW, to boost jobs and skills.

Train completion works include the final fit out, testing and commissioning works of the trains so they are ready for service.

A Review of Environmental Factors (REF) is currently being prepared to assess the potential impacts and to identify activities to manage and mitigate these impacts. The REF is expected to go on public display for community comment later this year.

## Jobs, skills and industry participation

We are developing a regional Jobs, Skills and Industry Participation Plan to ensure opportunities for people and businesses in regional NSW are maximised.

A briefing was held with key government and local stakeholders in February and an industry briefing was held in mid-April. More than 100 businesses and about 200 people attended the industry briefing, including the three shortlisted tenderers for the project. At the briefing businesses had an opportunity to talk to each of the shortlisted tenderers and get a better understanding of the project and business opportunities that may be available.

The briefing was delivered in partnership with the Office of Regional Development and Dubbo Regional Council, and focused on generating opportunities, including sustainable employment and Aboriginal participation in the project.



Justin Brooker and Yvette King (Transport for NSW) and Josie Howard (Dubbo Regional Council) at the briefing

**Would you like to know more?** Visit [transport.nsw.gov.au/projects/current-projects/regional-rail](https://transport.nsw.gov.au/projects/current-projects/regional-rail)

For more information call 1800 684 490

Email [projects@transport.nsw.gov.au](mailto:projects@transport.nsw.gov.au) or visit [transport.nsw.gov.au/projects](https://transport.nsw.gov.au/projects)

For urgent enquiries or complaints regarding construction activities, please call 24 hours 1800 775 465

# Fleet Status update

Project	Scope	Supplier	Overall status	
Inner Harbour Ferries	Six new ferries to be operated between Cockatoo Island and Watsons Bay.	Incat	Delivered in December 2017.	
New Intercity Fleet	512 new passenger carriages making up 55.5 trains of 8 and 10-car length.	RailConnect (Hyundai Rotem/Mitsubishi/UGL)	In progress. Detailed train design and supporting works underway.	
Parramatta River Ferries	Four new ferries for the Parramatta River.	To be decided	Delivery model under review.	
Regional Rail Project	New trains replacing 60 XPT, 23 XPLOER and 28 Endeavour passenger cars.	To be decided	Tender process underway.	
Sydney Growth Trains	24, 8-car double deck suburban electric trains.	Downer	In progress. Trains in production.	



This document contains important information about public transport projects in your area. If you require the services of an interpreter, please contact the Translating and Interpreting Service on **131 450** and ask them to call Transport for NSW on **(02) 9200 0200**. The interpreter will then assist you with translation.

For more information call 1800 684 490

Email [projects@transport.nsw.gov.au](mailto:projects@transport.nsw.gov.au) or visit [transport.nsw.gov.au/projects](http://transport.nsw.gov.au/projects)

For urgent enquiries or complaints regarding construction activities, please call 24 hours 1800 775 465